

The firm flexible Tubing is pushed over the integrated barbed side. It is fixed by knurled nut which presses a cutting ring to a sealing which forms a tightness for the connection. The shear force of the cutting ring intensifies the contact pressure. A solid, friction-locked, leak-tight and removable connection with low dead volume is the result.

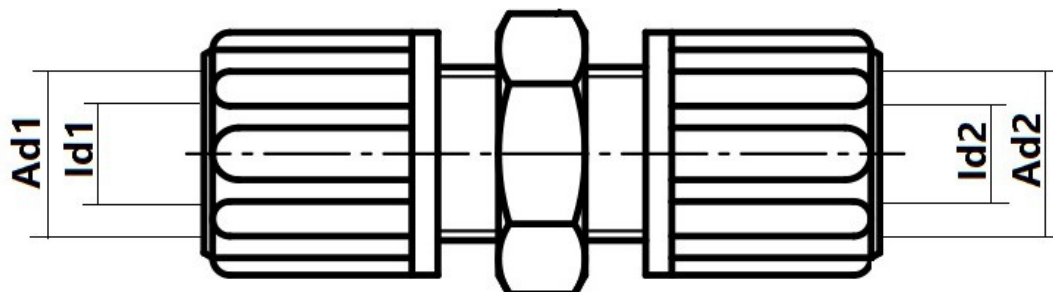

<b>Id1 = Inner-Ø Tubing 1:</b>	<b>Ad1 = Outer-Ø Tubing 1:</b>	<b>Id2 = Inner-Ø Tubing 2:</b>	<b>Ad2 = Outer-Ø Tubing 2:</b>
<ul style="list-style-type: none"> <li>○ 3,18 mm (1/8")</li> <li>○ 3,97 mm (5/32")</li> <li>○ 4,0 mm</li> <li>○ 5,0 mm</li> <li>○ 6,0 mm</li> <li>○ 6,35 mm (1/4")</li> <li>○ 7,94 mm (5/16")</li> <li>○ 8,0 mm</li> <li>○ 9,0 mm</li> <li>○ 9,53 mm (3/8")</li> <li>○ 10,0 mm</li> <li>○ 12,0 mm</li> <li>○ 14,0 mm</li> <li>○ 15,88 mm (5/8")</li> <li>○ 16,0 mm</li> <li>○ 18,0 mm</li> </ul>	<ul style="list-style-type: none"> <li>○ 6,0 mm</li> <li>○ 6,35 mm (1/4")</li> <li>○ 8,0 mm</li> <li>○ 9,0 mm</li> <li>○ 9,53 mm (3/8")</li> <li>○ 10,0 mm</li> <li>○ 12,0 mm</li> <li>○ 12,7 mm (1/2")</li> <li>○ 14,0 mm</li> <li>○ 16,0 mm</li> <li>○ 19,05 mm (3/4")</li> <li>○ 20,0 mm</li> </ul>	<ul style="list-style-type: none"> <li>○ 3,18 mm (1/8")</li> <li>○ 3,97 mm (5/32")</li> <li>○ 4,0 mm</li> <li>○ 4,23 mm (1/6")</li> <li>○ 5,0 mm</li> <li>○ 6,0 mm</li> <li>○ 6,35 mm (1/4")</li> <li>○ 8,0 mm</li> <li>○ 9,53 mm (3/8")</li> <li>○ 10,0 mm</li> <li>○ 12,0 mm</li> <li>○ 14,0 mm</li> <li>○ 15,88 mm (5/8")</li> <li>○ 16,0 mm</li> <li>○ 18,0 mm</li> </ul>	<ul style="list-style-type: none"> <li>○ 6,0 mm</li> <li>○ 6,35 mm (1/4")</li> <li>○ 8,0 mm</li> <li>○ 9,0 mm</li> <li>○ 9,53 mm (3/8")</li> <li>○ 10,0 mm</li> <li>○ 12,0 mm</li> <li>○ 12,7 mm (1/2")</li> <li>○ 14,0 mm</li> <li>○ 16,0 mm</li> <li>○ 19,05 mm (3/4")</li> <li>○ 20,0 mm</li> </ul>

**Material:**

- PFA
- PVDF
- Polypropylene

## Straight PFA Tubing Connector Standard Sizes

<b>Part number</b>	<b>Id1 = Inner-Ø Tubing 1:</b>	<b>Ad1 = Outer-Ø Tubing1:</b>	<b>Id2 = Inner-Ø Tubing 2:</b>	<b>Ad2 = Outer-Ø Tubing2:</b>	<b>Material:</b>
PFGV0001	3,18 mm (1/8")	6,35 mm (1/4")	3,18 mm (1/8")	6,35 mm (1/4")	PFA
PFGV0002	3,18 mm (1/8")	6,35 mm (1/4")	6,0 mm	8,0 mm	PFA
PFGV0003	3,18 mm (1/8")	6,35 mm (1/4")	6,35 mm (1/4")	9,53 mm (3/8")	PFA
PFGV0004	3,97 mm (5/32")	6,35 mm (1/4")	4,0 mm	6,0 mm	PFA
PFGV0005	3,97 mm (5/32")	6,35 mm (1/4")	6,35 mm (1/4")	9,53 mm (3/8")	PFA
PFGV0006	4,0 mm	6,0 mm	4,0 mm	6,0 mm	PFA
PFGV0007	4,0 mm	6,0 mm	4,23 mm (1/6")	6,35 mm (1/4")	PFA
PFGV0008	4,0 mm	6,0 mm	5,0 mm	8,0 mm	PFA
PFGV0009	4,0 mm	6,0 mm	6,0 mm	8,0 mm	PFA
PFGV0010	4,0 mm	6,0 mm	6,0 mm	10,0 mm	PFA
PFGV0011	4,0 mm	6,0 mm	8,0 mm	10,0 mm	PFA
PFGV0012	4,0 mm	6,0 mm	8,0 mm	12,0 mm	PFA

**OPTUBUS GmbH – [www.optubus.de](http://www.optubus.de) – [info@optubus.com](mailto:info@optubus.com)**

OPTUBUS believes that the information in this technical data sheet is an accurate description of the typical uses of the product. OPTUBUS, however, disclaims any liability for incidental or consequent damages, which may result from the use of the product that are beyond its control. Therefore it is the user's responsibility to thoroughly test the product in their particular application to determine its performance, efficiency and safety. Nothing contained herein is to be considered as permission or a recommendation to infringe any patent or any other intellectual property right.



Part number	Id1 = Inner-Ø Tubing 1:	Ad1 = Outer-Ø Tubing1:	Id2 = Inner-Ø Tubing 2:	Ad2 = Outer-Ø Tubing2:	Material:
PFGV0013	4,0 mm	6,0 mm	10,0 mm	12,0 mm	PFA
PFGV0014	6,0 mm	8,0 mm	8,0 mm	10,0 mm	PFA
PFGV0015	6,0 mm	8,0 mm	10,0 mm	12,0 mm	PFA
PFGV0016	6,0 mm	10,0 mm	6,0 mm	10,0 mm	PFA
PFGV0017	4,23 mm (1/6")	6,35 mm (1/4")	4,23 mm (1/6")	6,35 mm (1/4")	PFA
PFGV0018	4,23 mm (1/6")	6,35 mm (1/4")	6,35 mm (1/4")	9,53 mm (3/8")	PFA
PFGV0019	5,0 mm	8,0 mm	5,0 mm	8,0 mm	PFA
PFGV0020	6,0 mm	8,0 mm	6,0 mm	8,0 mm	PFA
PFGV0021	6,0 mm	8,0 mm	6,35 mm (1/4")	9,53 mm (3/8")	PFA
PFGV0022	6,0 mm	8,0 mm	8,0 mm	12,0 mm	PFA
PFGV0023	6,0 mm	9,0 mm	6,0 mm	9,0 mm	PFA
PFGV0024	6,35 mm (1/4")	9,53 mm (3/8")	6,35 mm (1/4")	9,53 mm (3/8")	PFA
PFGV0025	6,35 mm (1/4")	9,53 mm (3/8")	3,97 mm (5/32")	6,35 mm (1/4")	PFA
PFGV0026	6,35 mm (1/4")	9,53 mm (3/8")	4,23 mm (1/6")	6,35 mm (1/4")	PFA
PFGV0027	6,35 mm (1/4")	9,53 mm (3/8")	9,53 mm (3/8")	12,7 mm (1/2")	PFA
PFGV0028	6,35 mm (1/4")	9,53 mm (3/8")	10,0 mm	12,0 mm	PFA
PFGV0029	7,94 mm (5/16")	9,53 mm (3/8")	7,94 mm (5/16")	9,53 mm (3/8")	PFA
PFGV0030	8,0 mm	10,0 mm	8,0 mm	10,0 mm	PFA
PFGV0031	8,0 mm	10,0 mm	9,53 mm (3/8")	12,7 mm (1/2")	PFA
PFGV0032	8,0 mm	10,0 mm	10,0 mm	12,0 mm	PFA
PFGV0033	8,0 mm	10,0 mm	10,0 mm	14,0 mm	PFA
PFGV0034	8,0 mm	10,0 mm	16,0 mm	18,0 mm	PFA
PFGV0035	8,0 mm	12,0 mm	8,0 mm	12,0 mm	PFA
PFGV0036	9,0 mm	12,0 mm	9,0 mm	12,0 mm	PFA
PFGV0037	9,53 mm (3/8")	12,7 mm (1/2")	9,53 mm (3/8")	12,7 mm (1/2")	PFA
PFGV0038	9,53 mm (3/8")	12,7 mm (1/2")	10,0 mm	12,0 mm	PFA
PFGV0039	9,53 mm (3/8")	12,7 mm (1/2")	15,88 mm (5/8")	19,05 mm (3/4")	PFA
PFGV0040	10,0 mm	12,0 mm	10,0 mm	12,0 mm	PFA
PFGV0041	10,0 mm	12,0 mm	12,0 mm	14,0 mm	PFA
PFGV0042	10,0 mm	14,0 mm	10,0 mm	14,0 mm	PFA
PFGV0043	12,0 mm	14,0 mm	12,0 mm	14,0 mm	PFA
PFGV0044	12,0 mm	16,0 mm	12,0 mm	16,0 mm	PFA
PFGV0045	14,0 mm	16,0 mm	14,0 mm	16,0 mm	PFA
PFGV0046	15,88 mm (5/8")	19,05 mm (3/4")	15,88 mm (5/8")	19,05 mm (3/4")	PFA
PFGV0047	16,0 mm	20,0 mm	16,0 mm	20,0 mm	PFA
PFGV0048	18,0 mm	20,0 mm	18,0 mm	20,0 mm	PFA

### Straight PVDF Tubing Connector Standard Sizes

Part number	Id1 = Inner-Ø Tubing 1:	Ad1 = Outer-Ø Tubing1:	Id2 = Inner-Ø Tubing 2:	Ad2 = Outer-Ø Tubing2:	Material:
PVGV0001	3,18 mm (1/8")	6,35 mm (1/4")	3,18 mm (1/8")	6,35 mm (1/4")	PVDF
PVGV0002	3,18 mm (1/8")	6,35 mm (1/4")	6,0 mm	8,0 mm	PVDF
PVGV0003	3,18 mm (1/8")	6,35 mm (1/4")	9,53 mm (3/8")	12,7 mm (1/2")	PVDF
PVGV0004	3,97 mm (5/32")	6,35 mm (1/4")	3,97 mm (5/32")	6,35 mm (1/4")	PVDF
PVGV0005	3,97 mm (5/32")	6,35 mm (1/4")	4,0 mm	6,0 mm	PVDF
PVGV0006	4,0 mm	6,0 mm	4,0 mm	6,0 mm	PVDF
PVGV0007	4,0 mm	6,0 mm	6,0 mm	8,0 mm	PVDF
PVGV0008	4,0 mm	6,0 mm	6,0 mm	10,0 mm	PVDF
PVGV0009	4,0 mm	6,0 mm	6,35 mm (1/4")	9,53 mm (3/8")	PVDF
PVGV0010	4,0 mm	6,0 mm	8,0 mm	10,0 mm	PVDF
PVGV0011	4,0 mm	6,0 mm	8,0 mm	12,0 mm	PVDF
PVGV0012	4,0 mm	6,0 mm	9,0 mm	12,0 mm	PVDF
PVGV0013	4,0 mm	6,0 mm	10,0 mm	12,0 mm	PVDF
PVGV0014	4,23 mm (1/6")	6,35 mm (1/4")	4,0 mm	6,0 mm	PVDF
PVGV0015	4,23 mm (1/6")	6,35 mm (1/4")	4,23 mm (1/6")	6,35 mm (1/4")	PVDF
PVGV0016	4,23 mm (1/6")	6,35 mm (1/4")	6,35 mm (1/4")	9,53 mm (3/8")	PVDF
PVGV0017	5,0 mm	8,0 mm	5,0 mm	8,0 mm	PVDF
PVGV0018	6,0 mm	8,0 mm	6,0 mm	8,0 mm	PVDF
PVGV0019	6,0 mm	8,0 mm	6,35 mm (1/4")	9,53 mm (3/8")	PVDF
PVGV0020	6,0 mm	8,0 mm	6,0 mm	10,0 mm	PVDF
PVGV0021	6,0 mm	8,0 mm	8,0 mm	10,0 mm	PVDF
PVGV0022	6,0 mm	8,0 mm	8,0 mm	12,0 mm	PVDF
PVGV0023	6,0 mm	8,0 mm	9,53 mm (3/8")	12,7 mm (1/2")	PVDF
PVGV0024	6,0 mm	8,0 mm	10,0 mm	12,0 mm	PVDF
PVGV0025	6,0 mm	9,0 mm	6,0 mm	9,0 mm	PVDF
PVGV0026	6,0 mm	10,0 mm	6,0 mm	10,0 mm	PVDF
PVGV0027	6,0 mm	10,0 mm	10,0 mm	12,0 mm	PVDF
PVGV0028	6,35 mm (1/4")	9,53 mm (3/8")	8,0 mm	10,0 mm	PVDF
PVGV0029	8,0 mm	10,0 mm	8,0 mm	10,0 mm	PVDF
PVGV0030	8,0 mm	10,0 mm	10,0 mm	12,0 mm	PVDF
PVGV0031	8,0 mm	12,0 mm	8,0 mm	12,0 mm	PVDF
PVGV0032	9,0 mm	12,0 mm	9,0 mm	12,0 mm	PVDF
PVGV0033	9,53 mm (3/8")	12,7 mm (1/2")	8,0 mm	10,0 mm	PVDF
PVGV0034	9,53 mm (3/8")	12,7 mm (1/2")	9,53 mm (3/8")	12,7 mm (1/2")	PVDF
PVGV0035	9,53 mm (3/8")	12,7 mm (1/2")	10,0 mm	12,0 mm	PVDF
PVGV0036	10,0 mm	12,0 mm	10,0 mm	12,0 mm	PVDF
PVGV0037	12,0 mm	14,0 mm	12,0 mm	14,0 mm	PVDF

**OPTUBUS GmbH – [www.optubus.de](http://www.optubus.de) – [info@optubus.com](mailto:info@optubus.com)**

OPTUBUS believes that the information in this technical data sheet is an accurate description of the typical uses of the product. OPTUBUS, however, disclaims any liability for incidental or consequent damages, which may result from the use of the product that are beyond its control. Therefore it is the user's responsibility to thoroughly test the product in their particular application to determine its performance, efficiency and safety. Nothing contained herein is to be considered as permission or a recommendation to infringe any patent or any other intellectual property right.



Part number	Id1 = Inner-Ø Tubing 1:	Ad1 = Outer-Ø Tubing1:	Id2 = Inner-Ø Tubing 2:	Ad2 = Outer-Ø Tubing2:	Material:
PVGV0038	12,0 mm	16,0 mm	12,0 mm	16,0 mm	PVDF
PVGV0039	15,88 mm (5/8")	19,05 mm (3/4")	15,88 mm (5/8")	19,05 mm (3/4")	PVDF

## Straight PP Tubing Connector Standard Sizes

Part number	Id1 = Inner-Ø Tubing 1:	Ad1 = Outer-Ø Tubing1:	Id2 = Inner-Ø Tubing 2:	Ad2 = Outer-Ø Tubing2:	Material:
PPGV0001	3,97 mm (5/32")	6,35 mm (1/4")	4,0 mm	6,0 mm	PP
PPGV0002	4,23 mm (1/6")	6,35 mm (1/4")	4,23 mm (1/6")	6,35 mm (1/4")	PP
PPGV0003	4,23 mm (1/6")	6,35 mm (1/4")	6,35 mm (1/4")	9,53 mm (3/8")	PP
PPGV0004	4,0 mm	6,0 mm	4,0 mm	6,0 mm	PP
PPGV0005	4,0 mm	6,0 mm	6,0 mm	8,0 mm	PP
PPGV0006	5,0 mm	8,0 mm	5,0 mm	8,0 mm	PP
PPGV0007	9,53 mm (3/8")	12,7 mm (1/2")	15,88 mm (5/8")	19,05 mm (3/4")	PP